

FLAT FACE - QCF SERIES

UNF MALE



TECHNICAL FEATURES AND OPTIONS

[CLICK HERE FOR 3D SECTION](#)

- Locking Mechanism**
Locking Ball System
+Safety Lock
- Flow Rate**
Up to 189 l / min
- Material**
Carbon Steel
Stainless Steel
Brass
- Working Temperature**
-20 °C / +90 °C
- Interchange**
16028
- How to Connect**
Push
- Operating Pressure**
Up to 250 Bar
- Available Threads**
BSP - NPT - Metric - SAE
- Under Residual Pressure**
Connction: Not Allowed
Disconnection: Not Allowed
- Body Sizes**
ISO 6.3-25
- Sealing Description**
NBR - FKM
- Valve Type**
Flat Face

MAIN APPLICATIONS

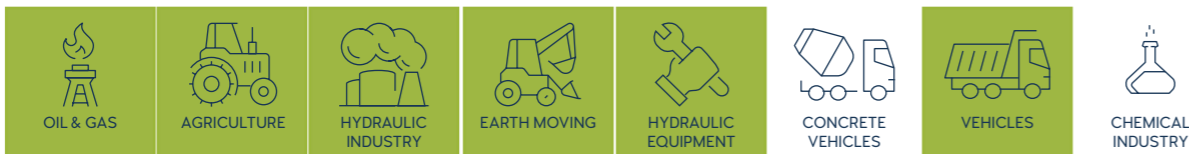

TECHNICAL DRAWING

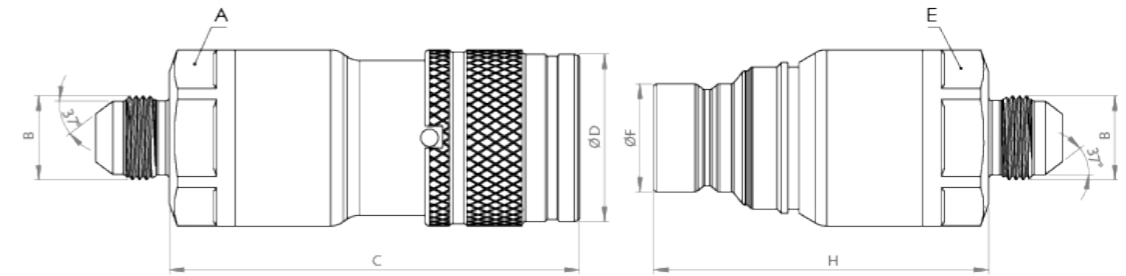

BODY SIZE	DESCRIPTION	COUPLING GENDER	Hex		THREAD SIZE (B)	DIAMETER		LENGTH		WEIGHT				
			mm	inch		mm	inch	mm	inch	kg	lbs			
06	QCF-6A-MSAE6	FEMALE	A	26	1.02	9/16-18 UNF	D	28	1.1	C	86.1	3.39	0.24	0.53
	QCF-6B-MSAE6	MALE	E	26	1.02	9/16-18 UNF	F	16.15	0.64	H	76.1	3	0.16	0.35
10	QCF-10A-MSAE6	FEMALE	A	30	1.18	9/16-18 UNF	D	32	1.25	C	84	3.30	0.39	0.858
	QCF-10B-MSAE6	MALE	E	30	1.18	9/16-18 UNF	F	19.7	0.77	H	74	2.91	0.24	0.528
	QCF-10A-MSAE8	FEMALE	A	30	1.18	3/4 -16 UNF	D	32	1.25	C	83	3.26	0.4	0.88
	QCF-10B-MSAE8	MALE	E	30	1.18	3/4 -16 UNF	F	19.7	0.77	H	73	2.87	0.25	0.55
12.5	QCF-10A-MSAE10	FEMALE	A	30	1.18	7/8-14 UNF	D	32	1.25	C	83	3.26	0.4	0.88
	QCF-10B-MSAE10	MALE	E	30	1.18	7/8-14 UNF	F	19.7	0.77	H	73	2.87	0.26	0.572
	QCF-12A-MSAE8	FEMALE	A	36	1.41	3/4 -16 UNF	D	38	1.49	C	99	3.89	0.63	1.386
19	QCF-12B-MSAE8	MALE	E	36	1.41	3/4-16UNF	F	24.5	0.96	H	82	3.22	0.4	0.88
	QCF-12A-MSAE10	FEMALE	A	36	1.41	7/8-14UNF	D	38	1.49	C	98	3.85	0.64	1.408
	QCF-12B-MSAE10	MALE	E	36	1.41	7/8-14 UNF	F	24.5	0.96	H	81	3.18	0.41	0.902
25	QCF-19A-MSAE12	FEMALE	A	41	1.61	11/16 -12UN	D	46.1	1.81	C	116	4.56	1	2.2
	QCF-19B-MSAE12	MALE	E	41	1.61	11/16-12 UN	F	29.9	1.17	H	97	3.81	0.62	1.364
25	QCF-25A-MSAE16	FEMALE	A	50	1.96	1 5/16-12UN	D	55	2.16	C	123	4.84	1.56	3.432
	QCF-25B-MSAE16	MALE	E	50	1.96	1 5/16-12UN	F	36	1.41	H	106	4.17	0.98	2.156

ISO8434-2

BODY SIZE	WORKING PRESSURE						BURST PRESSURE					
	COUPLE		FEMALE		MALE		COUPLE		FEMALE		MALE	
	MPa	PSI	MPa	PSI	MPa	PSI	MPa	PSI	MPa	PSI	MPa	PSI
6	31,5	4568	31,5	4568	31,5	4568	126	18270	126	18270	126	18270
10	25	3625	25	3625	25	3625	100	14500	100	14500	100	14500
12,5	25	3625	25	3625	25	3625	100	14500	100	14500	100	14500
19	25	3625	25	3625	25	3625	100	14500	100	14500	100	14500
25	20	2900	20	2900	20	2900	80	11600	80	11600	80	11600

INFORMATION

- Flat face design prevents dirt and dust accumulation in the system.
- Top quality elastomer seals provide maximum sealing and prevent oil leakage during disconnection.
- Laminar flow prevents pressure drops and turbulences.
- Durable, safe, compact and easy to use design.
- Please clean the mating surfaces thoroughly before connecting, in order to prevent contaminants to enter into the system.
- Please make sure that the male and female parts are aligned properly to achieve full connection.
- Safety lock feature prevents accidental disconnection.

WARNING

- Connection and disconnection under dynamic pressure is not allowed.
- Connection and disconnection is not allowed when the temperature of the circulating fluid is above 80°C / 176°F.
- Make sure the system pressure is below the maximum working pressure.
- Please ensure that the OLEOCON product you have chosen is compatible with the temperature, material and pressure requirements of your system.
- Please contact OLEOCON technical support for any further questions.